

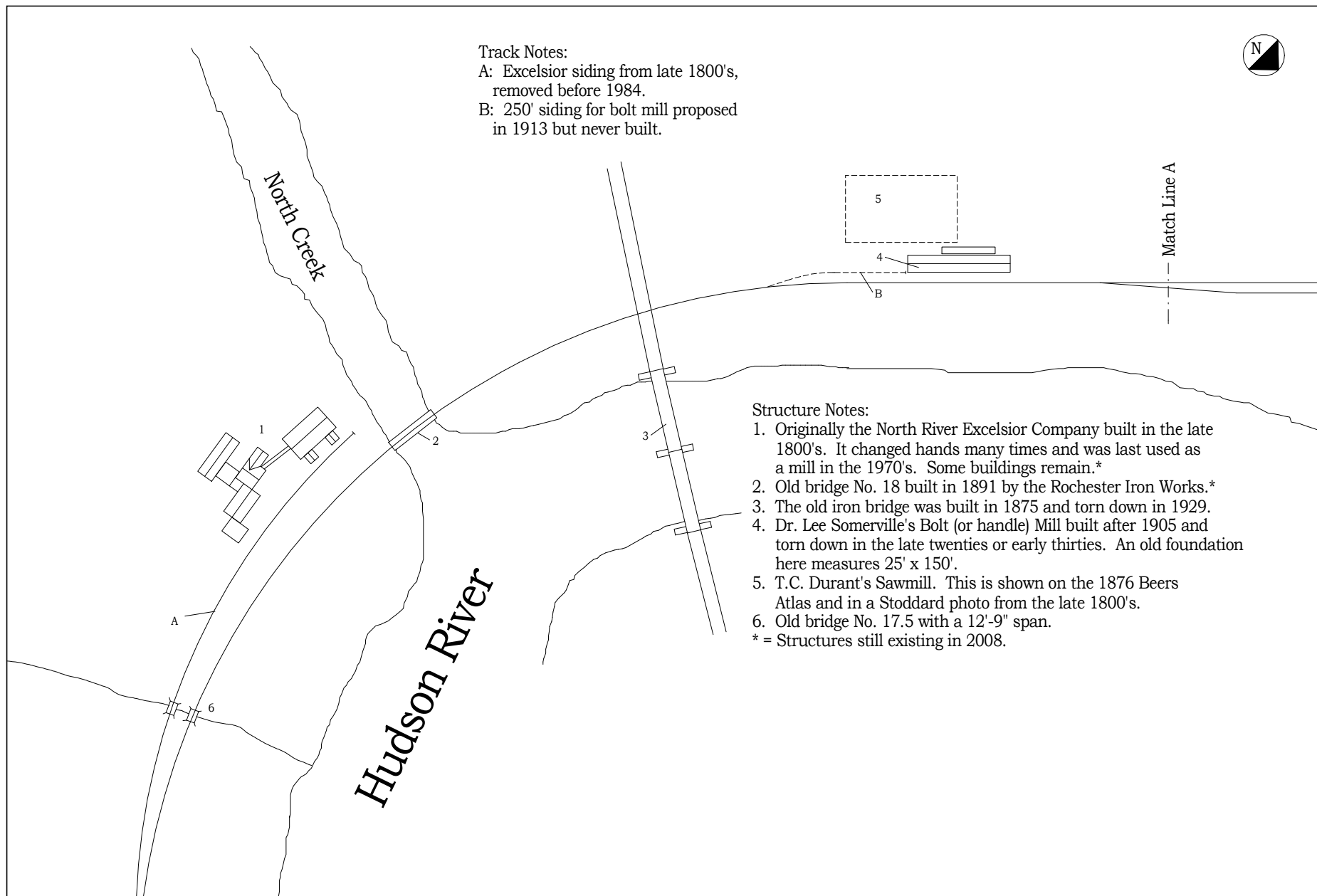

Track Notes:  
A: Excelsior siding from late 1800's,  
removed before 1984.  
B: 250' siding for bolt mill proposed  
in 1913 but never built.

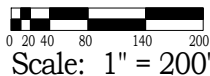

Structure Notes:  
1. Originally the North River Excelsior Company built in the late 1800's. It changed hands many times and was last used as a mill in the 1970's. Some buildings remain.\*  
2. Old bridge No. 18 built in 1891 by the Rochester Iron Works.\*  
3. The old iron bridge was built in 1875 and torn down in 1929.  
4. Dr. Lee Somerville's Bolt (or handle) Mill built after 1905 and torn down in the late twenties or early thirties. An old foundation here measures 25' x 150'.  
5. T.C. Durant's Sawmill. This is shown on the 1876 Beers Atlas and in a Stoddard photo from the late 1800's.  
6. Old bridge No. 17.5 with a 12'-9" span.  
\* = Structures still existing in 2008.



**DELAWARE & HUDSON RAILROAD**  
North Creek Yard / South End c.1900

Based on Adirondack Rwy. Atlas from 1891 and photos.  
Drawn by Jon Patton, rev. 1/8/2009.