

Track Notes:
 A: Mill siding removed c.1970.

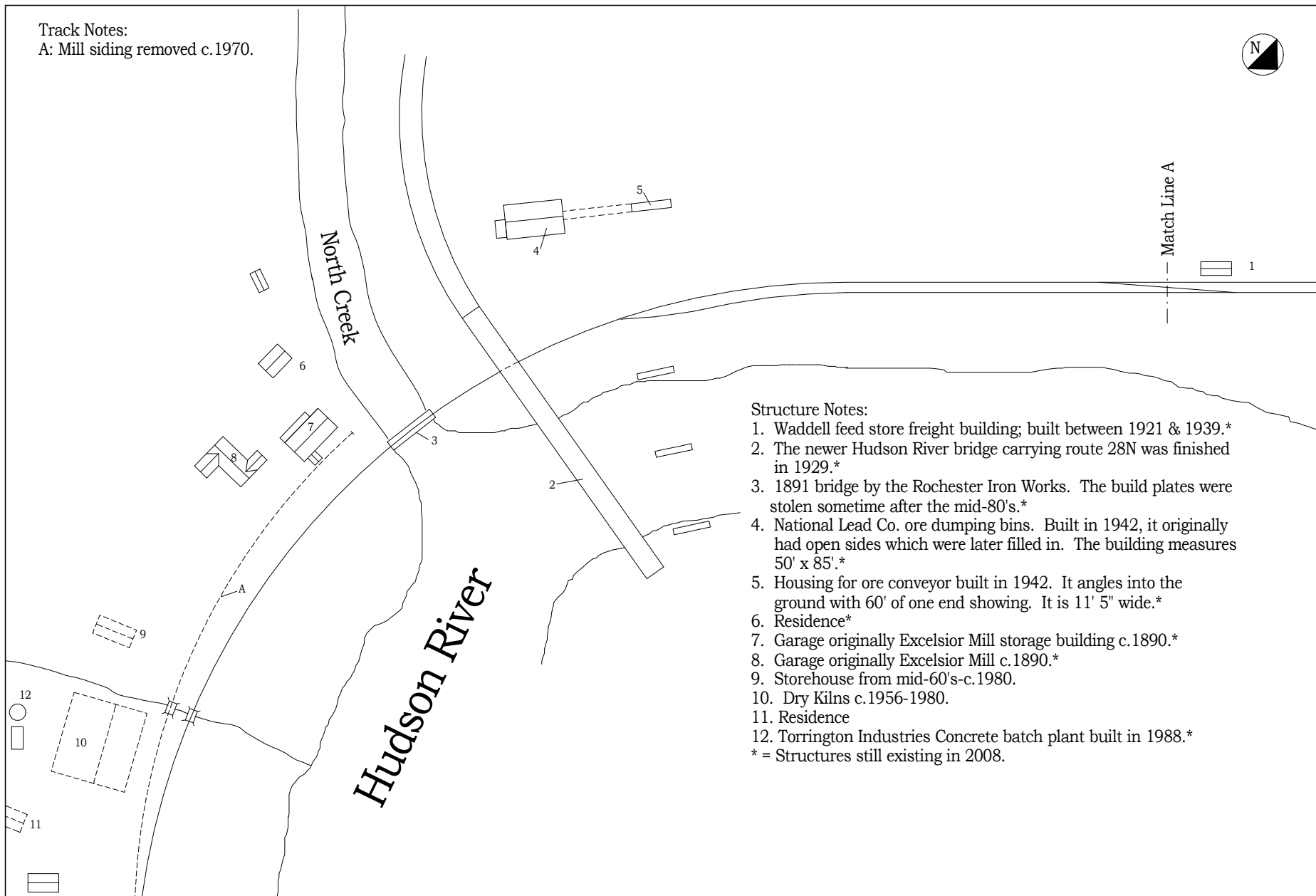

Structure Notes:

1. Waddell feed store freight building; built between 1921 & 1939.*
 2. The newer Hudson River bridge carrying route 28N was finished in 1929.*
 3. 1891 bridge by the Rochester Iron Works. The build plates were stolen sometime after the mid-80's.*
 4. National Lead Co. ore dumping bins. Built in 1942, it originally had open sides which were later filled in. The building measures 50' x 85'.*
 5. Housing for ore conveyor built in 1942. It angles into the ground with 60' of one end showing. It is 11' 5" wide.*
 6. Residence*
 7. Garage originally Excelsior Mill storage building c.1890.*
 8. Garage originally Excelsior Mill c.1890.*
 9. Storehouse from mid-60's-c.1980.
 10. Dry Kilns c.1956-1980.
 11. Residence
 12. Torrington Industries Concrete batch plant built in 1988.*
- * = Structures still existing in 2008.

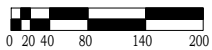

Scale: 1" = 200'

DELAWARE & HUDSON RAILROAD
 North Creek Yard / South End c.1985

Based on photos.
 Drawn by Jon Patton, rev. 1/10/2009.